

184 159

TESLA



SUPERCHARGING STATION

FREDERICK
 MD015_FREDERICK
 5500 BUCKEYSTOWN PIKE
 FREDERICK, MD 21703

RECEIVED
 SEP 04 2018
 By

Fredrick County, MD
 APPROVED
 SEP 18 2018
 Dept. of Planning & Development Review

DEVELOPMENT REVIEW
 FILE # SP74-01
 PROJECT 18710
 DATE _____

TESLA
 MOTORS, INC.

3500 DEER CREEK RD
 PALO ALTO, CA 94304
 (855) 681-5000



BLACK & VEATCH

6800 W 115th St, Suite 2202
 OVERLAND PARK, KS 66211
 (913) 458-2000

PROJECT NO: 192745
 DRAWN BY: AJKJ
 CHECKED BY: CNS

SITE INFORMATION	APPLICABLE CODES	PROJECT DESCRIPTION	ZONING INFORMATION	DRAWING INDEX
------------------	------------------	---------------------	--------------------	---------------

PROPOSED TESLA EV SITE ADDRESS:
 5500 BUCKEYSTOWN PIKE, SUITE EV
 FREDERICK, MD 21703

EXISTING SITE ADDRESS:
 5500 BUCKEYSTOWN PIKE
 FREDERICK, MD 21703

PROPERTY OWNER:
 MARK VOYDABOFF, CMD, SLD
 (215) 875-0764
 MARK.VOYDANOFF@PREIT.COM

EQUIPMENT SUPPLIER:
 TESLA MOTORS, INC.
 3500 DEER CREEK RD
 PALO ALTO, CA 94304
 (855) 681-5000

POWER COMPANY:
 FIRST ENERGY CORP.
 CONTACT: BRYCE MCCUSKER
 (301) 694-4474

COUNTY:
 FREDERICK

LATITUDE (NAD83):
 39° 22' 57.356" N
 39.382599°

LONGITUDE (NAD83):
 77° 24' 50.596" W
 -77.405721°

CONTACT ENGINEER:
 RUSSELL POLLOM
 (813) 458-6274
 PALO ALTO, CA 94304
 (855) 681-5000

POWER COMPANY:
 FIRST ENERGY CORP.
 CONTACT: BRYCE MCCUSKER
 (301) 694-4474

COUNTY:
 FREDERICK

LATITUDE (NAD83):
 39° 22' 57.356" N
 39.382599°

LONGITUDE (NAD83):
 77° 24' 50.596" W
 -77.405721°

CONTACT ENGINEER:
 RUSSELL POLLOM
 (813) 458-6274
 POLLOMRE@BV.COM

ALL WORK SHALL COMPLY WITH THE FOLLOWING APPLICABLE CODES:

2015 INTERNATIONAL BUILDING CODE
 2015 INTERNATIONAL FUEL GAS CODE
 2015 INTERNATIONAL PLUMBING CODE
 2015 INTERNATIONAL MECHANICAL CODE
 2014 NATIONAL ELECTRICAL CODE
 2015 NFPA 101 LIFE SAFETY CODE
 2015 INTERNATIONAL ENERGY CONSERVATION CODE

IN THE EVENT OF CONFLICT, THE MOST RESTRICTIVE CODE SHALL PREVAIL

- INSTALL (5) TESLA SUPERCHARGER CABINETS
- INSTALL (10) TESLA CHARGING STATIONS
- INSTALL (1) QED SWITCHBOARD ASSEMBLY
- INSTALL (1) UTILITY TRANSFORMER
- INSTALL (2) PEDESTRIAN LIGHT POLES
- INSTALL (5) AUTOTRANSFORMERS

PERMITTING JURISDICTION: FREDERICK COUNTY
 ZONING CLASS: GC (GENERAL COMMERCIAL)

DO NOT SCALE DRAWINGS

CONTRACTOR SHALL VERIFY ALL PLANS, EXISTING DIMENSIONS & CONDITIONS ON THE JOB SITE & SHALL IMMEDIATELY NOTIFY THE ENGINEER IN WRITING OF ANY DISCREPANCIES BEFORE PROCEEDING WITH THE WORK.

SHEET NO:	SHEET TITLE	REV NO:
T-1	TITLE SHEET & PROJECT DATA	2
A-1	OVERALL SITE PLAN	2
A-2	DEMOLITION SITE PLAN	2
A-3	PROPOSED SITE PLAN	2
A-4	ENLARGED PROPOSED EQUIPMENT LAYOUT	2
A-5	SITE ELEVATIONS	2
A-6	FENCE DETAILS	2
E-1	UTILITY PLAN	2
E-1.1	UTILITY PLAN	2
E-2	ELECTRICAL PLAN	2
E-3	ELECTRICAL DETAILS	2
E-4	ELECTRICAL DETAILS	2
E-5	AUTOTRANSFORMER DETAILS	2
G-1	GROUNDING DETAILS	2
D-1	INSTALLATION DETAILS	2
D-2	INSTALLATION DETAILS	2
D-3	INSTALLATION DETAILS	2
LS-1	LANDSCAPING PLAN, DETAILS & PLANT SCHEDULE	2
GN-1	GENERAL NOTES 1	2
GN-2	GENERAL NOTES 2	2
GN-3	GENERAL NOTES 3	2

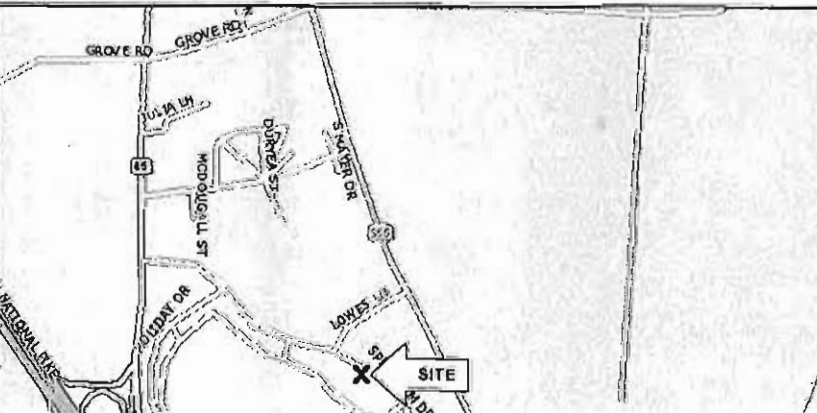
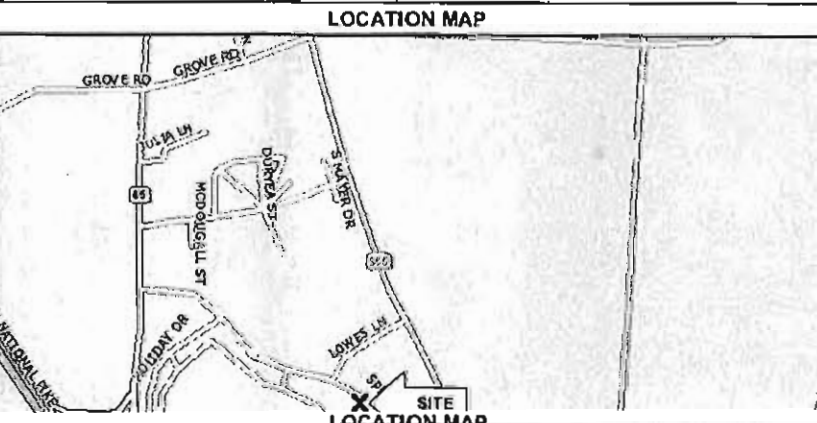

FOR REFERENCE ONLY

SHEET NO:	SHEET TITLE	REV NO:
E-4	ELECTRICAL DETAILS	2
E-5	AUTOTRANSFORMER DETAILS	2
G-1	GROUNDING DETAILS	2
D-1	INSTALLATION DETAILS	2
D-2	INSTALLATION DETAILS	2
D-3	INSTALLATION DETAILS	2
LS-1	LANDSCAPING PLAN, DETAILS & PLANT SCHEDULE	2
GN-1	GENERAL NOTES 1	2
GN-2	GENERAL NOTES 2	2
GN-3	GENERAL NOTES 3	2

FOR REFERENCE ONLY

SHEET NO:	SHEET TITLE	REV NO:
E-4	ELECTRICAL DETAILS	2
E-5	AUTOTRANSFORMER DETAILS	2
G-1	GROUNDING DETAILS	2
D-1	INSTALLATION DETAILS	2
D-2	INSTALLATION DETAILS	2
D-3	INSTALLATION DETAILS	2
LS-1	LANDSCAPING PLAN, DETAILS & PLANT SCHEDULE	2
GN-1	GENERAL NOTES 1	2
GN-2	GENERAL NOTES 2	2
GN-3	GENERAL NOTES 3	2

REV	DATE	DESCRIPTION
2	08/28/18	ISSUED FOR CONSTRUCTION
1	08/28/18	RESUBMITTED FOR PERMITTING
0	07/12/18	ISSUED FOR PERMITTING

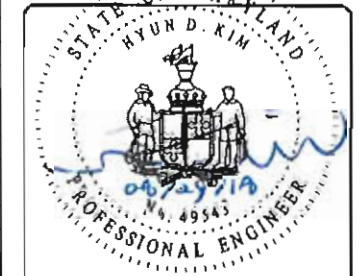

Professional Certification. I hereby certify that these documents were prepared or approved by me, and that I am a duly licensed professional engineer under the laws of the State of Maryland. License No. 49543. Expiration Date: 06/19/2020.

IT IS A VIOLATION OF LAW FOR ANY PERSON, UNLESS THEY ARE ACTING UNDER THE DIRECTION OF A LICENSED PROFESSIONAL ENGINEER, TO ALTER THIS DOCUMENT.



Professional Certification. I hereby certify that these documents were prepared or approved by me, and that I am a duly licensed professional engineer under the laws of the State of Maryland. License No. 49543. Expiration Date: 06/19/2020.

IT IS A VIOLATION OF LAW FOR ANY PERSON, UNLESS THEY ARE ACTING UNDER THE DIRECTION OF A LICENSED PROFESSIONAL ENGINEER, TO ALTER THIS DOCUMENT.

MD015_FREDERICK



3500 DEER CREEK RD
PALO ALTO, CA 94304
(650) 681-5000



BLACK & VEATCH

6800 W 115th St, Suite 2292
OVERLAND PARK, KS 66211
(913) 458-2000

PROJECT NO:	192745
DRAWN BY:	AJG
CHECKED BY:	CNS

REV	DATE	DESCRIPTION
2	05/28/18	ISSUED FOR CONSTRUCTION
1	06/04/18	REISSUED FOR PERMITTING
0	07/12/18	ISSUED FOR PERMITTING

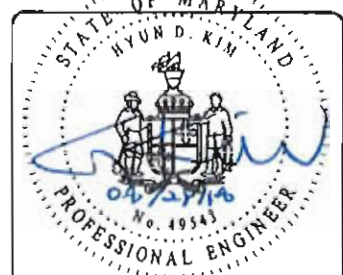

Professional Certification. I hereby certify that these documents were prepared or approved by me, and that I am a duly licensed professional engineer under the laws of the State of Maryland. License No. 49543, Expiration Date: 06/19/2020.

IT IS A VIOLATION OF LAW FOR ANY PERSON, UNLESS THEY ARE ACTING UNDER THE DIRECTION OF A LICENSED PROFESSIONAL ENGINEER, TO ALTER THIS DOCUMENT.



Professional Certification. I hereby certify that these documents were prepared or approved by me, and that I am a duly licensed professional engineer under the laws of the State of Maryland. License No. 49543, Expiration Date: 06/19/2020.

IT IS A VIOLATION OF LAW FOR ANY PERSON, UNLESS THEY ARE ACTING UNDER THE DIRECTION OF A LICENSED PROFESSIONAL ENGINEER, TO ALTER THIS DOCUMENT.

MD015, FREDERICK

Frederick County, MD

NOTE

1. THE CONTRACTOR SHALL VERIFY ALL DEMOLITION AND CONSTRUCTION QUANTITIES PRIOR TO BIDDING.

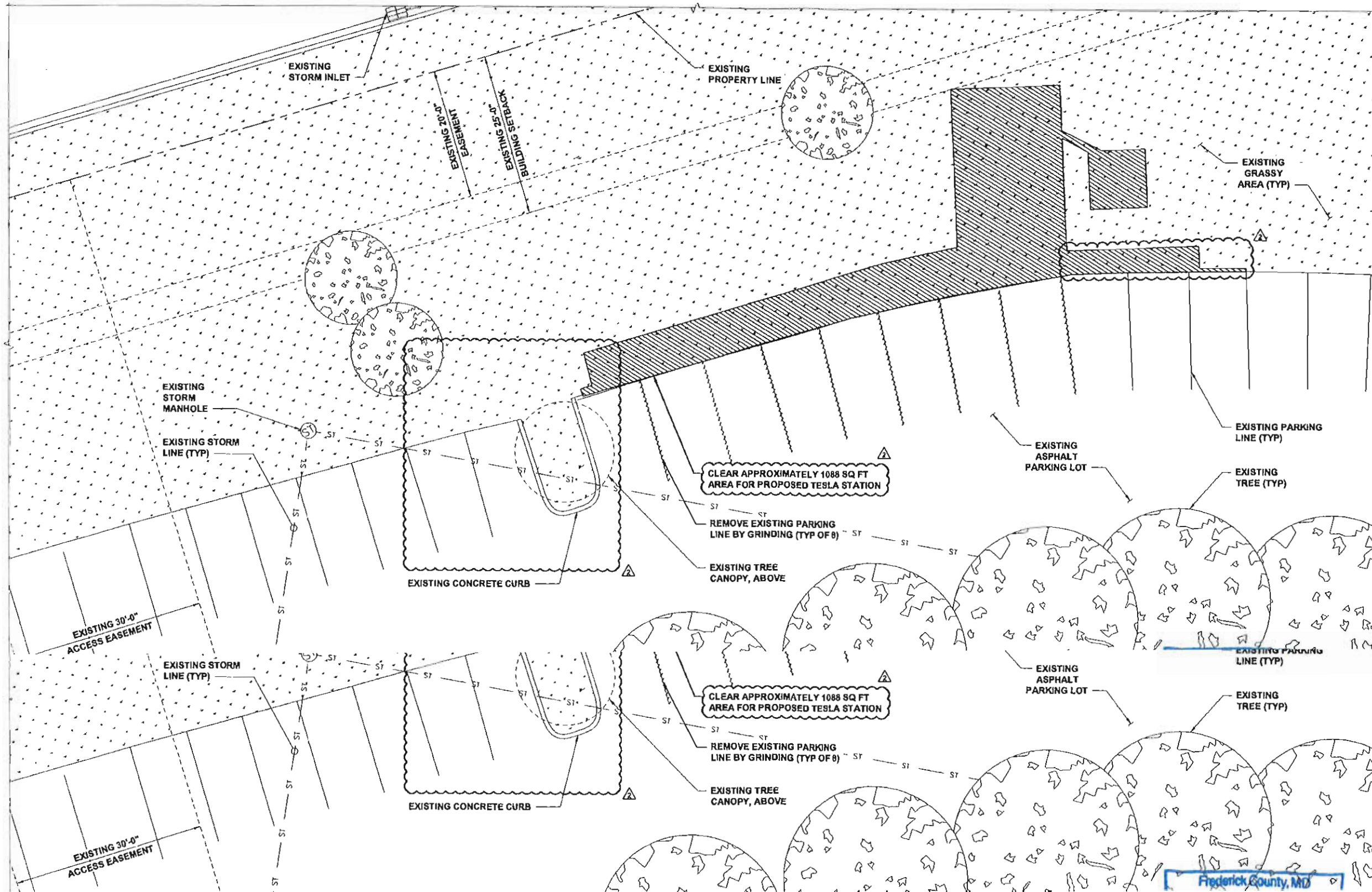

3500 DEER CREEK RD
PALO ALTO, CA 94304
(650) 681-5000



BLACK & VEATCH

6600 W 115th St, Suite 2292
OVERLAND PARK, KS 66211
(913) 458-2000

PROJECT NO:	102745
DRAWN BY:	AKJ
CHECKED BY:	CNS

REV	DATE	DESCRIPTION
2	08/29/18	ISSUED FOR CONSTRUCTION
1	03/05/18	REISSUED FOR PERMITTING
0	07/12/18	ISSUED FOR PERMITTING



Professional Certification. I hereby certify that these documents were prepared or approved by me, and that I am a duly licensed professional engineer under the laws of the State of Maryland. License No. 49343, Expiration Date: 06/19/2020

IT IS A VIOLATION OF LAW FOR ANY PERSON, UNLESS THEY ARE ACTING UNDER THE DIRECTION OF A LICENSED PROFESSIONAL ENGINEER, TO ALTER THIS DOCUMENT.

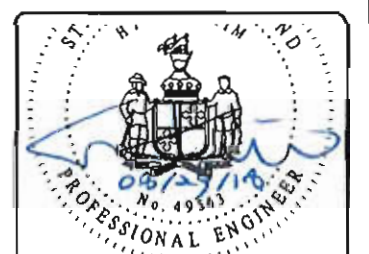

Professional Certification. I hereby certify that these documents were prepared or approved by me, and that I am a duly licensed professional engineer under the laws of the State of Maryland. License No. 49343, Expiration Date: 06/19/2020

IT IS A VIOLATION OF LAW FOR ANY PERSON, UNLESS THEY ARE ACTING UNDER THE DIRECTION OF A LICENSED PROFESSIONAL ENGINEER, TO ALTER THIS DOCUMENT.

MD015 FREDERICK COUNTY, MD

NOTES

- SOD PLANTED IN THE FALL MUST ESTABLISH ITS ROOTS BEFORE THE FIRST WINTER FROST. DETERMINE WHEN THE FIRST FROST USUALLY OCCURS, AND PLANT THE SOD NO LATER THAN ONE MONTH BEFORE THE FIRST FROST. IF THE CONSTRUCTION IS FINISHED LATER THAN ONE MONTH BEFORE THE FIRST FROST, USE STRAW UNTIL SOD CAN BE INSTALLED.
- FOR SIGNAGE INFORMATION SEE SHEET A-5.
- FILL SHALL BE ADDED BEHIND PROPOSED CURB TO BRING EXISTING GRADE FLUSH TO BACK OF CURB.
- LIGHTING SHALL NOT EXCEED 0.5 FOOTCANDLES AT THE PERIPHERY OF THE SITE. SEE REFERENCE SHEET : PHOTOMETRIC PLAN.

PROJECT AREA STALL COUNT	
EXISTING STALL COUNT	10
PROPOSED TESLA CHARGING STALLS	10

TESLA EQUIPMENT SCHEDULE			
TESLA EQUIPMENT	DESCRIPTION	PART NUMBER	QUANTITY
SUPERCHARGING CABINETS	GEN 2 L-N SUPERCHARGER	1033026-04-E	5
CHARGE POST BOLLARDS	BOLT DDWN BOLLARDS	1024070-01-D	10
CHARGE POST JUNCTION BOX	DUAL CONDUCTORS	1048082-00-A	10
CHARGE POST DOCK	NORTH AMERICA	1028384-00-C	10

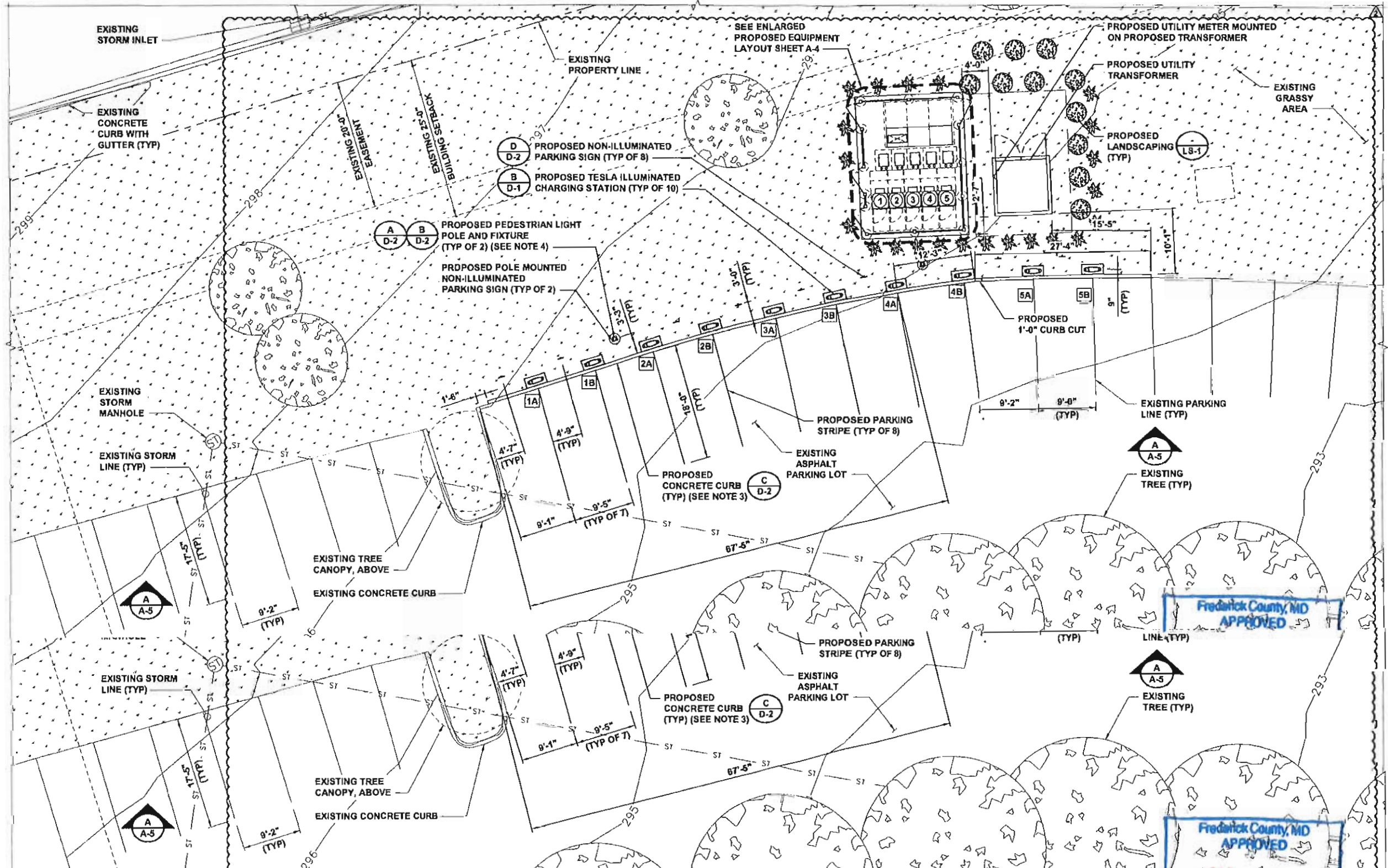

3500 DEER CREEK RD
PALO ALTO, CA 94304
(650) 551-5000



BLACK & VEATCH

6800 W 115th St, Suite 2202
OVERLAND PARK, KS 66211
(913) 458-2000

PROJECT NO:	192745
DRAWN BY:	AKJ
CHECKED BY:	CMS

REV	DATE	DESCRIPTION
2	03/29/18	ISSUED FOR CONSTRUCTION
1	08/08/18	REISSUED FOR PERMITTING
0	07/12/18	ISSUED FOR PERMITTING



Professional Certification: I hereby certify that these documents were prepared or approved by me, and that I am a duly licensed professional engineer under the laws of the State of Maryland. License No. 49543, Expiration Date: 06/19/2020

IT IS A VIOLATION OF LAW FOR ANY PERSON, UNLESS THEY ARE ACTING UNDER THE DIRECTION OF A LICENSED PROFESSIONAL ENGINEER, TO ALTER THIS DOCUMENT.

Frederick County, MD
APPROVED



Professional Certification: I hereby certify that these documents were prepared or approved by me, and that I am a duly licensed professional engineer under the laws of the State of Maryland. License No. 49543, Expiration Date: 06/19/2020

IT IS A VIOLATION OF LAW FOR ANY PERSON, UNLESS THEY ARE ACTING UNDER THE DIRECTION OF A LICENSED PROFESSIONAL ENGINEER, TO ALTER THIS DOCUMENT.

Frederick County, MD
APPROVED

MD015_FREDERICK
eEnergy

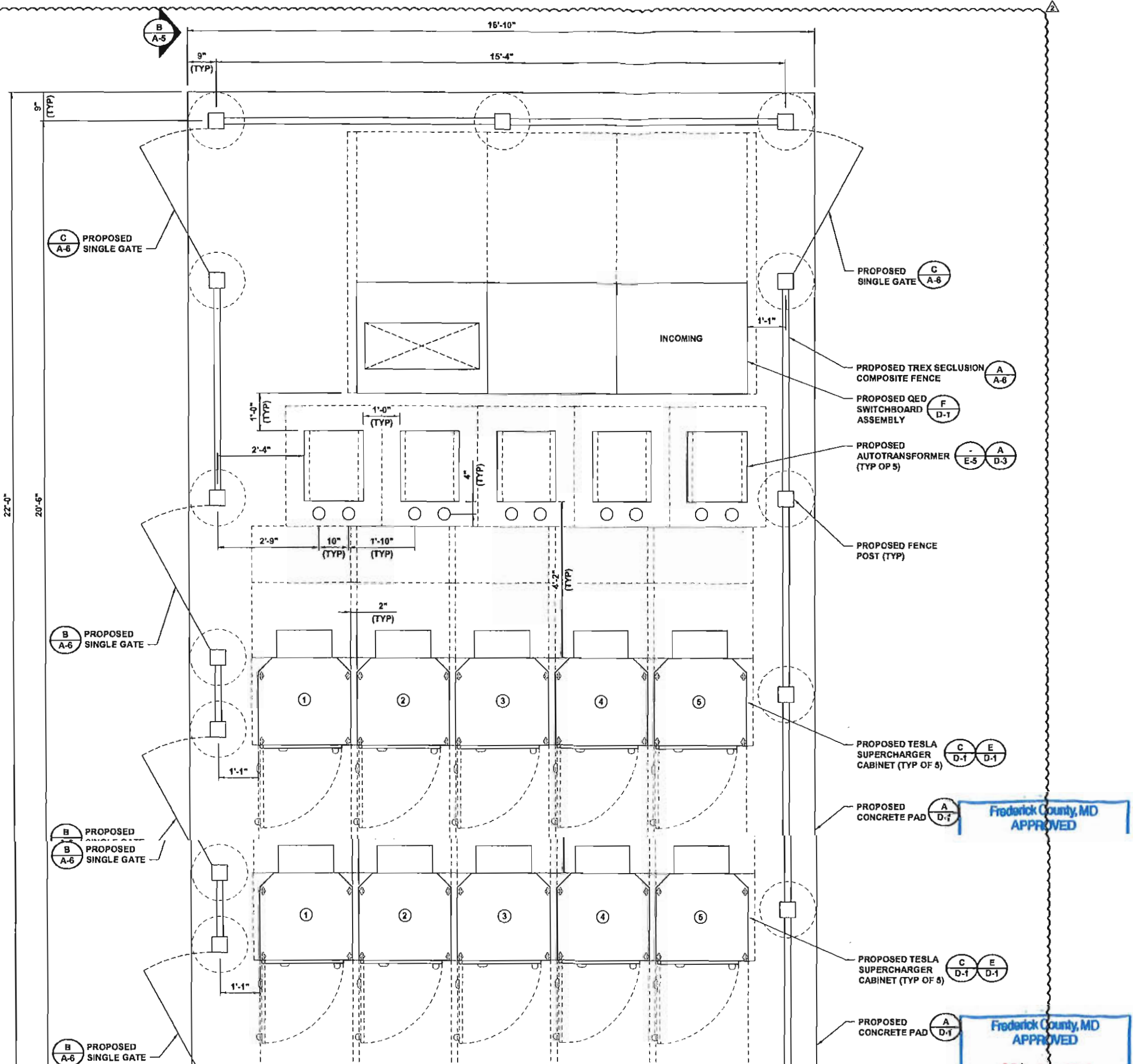

3500 DEER CREEK RD
PALO ALTO, CA 94304
(650) 881-5600



BLACK & VEATCH

8800 W 115th St, Suite 2202
OVERLAND PARK, KS 64211
(913) 458-2000

PROJECT NO:	192745
DRAWN BY:	AKJ
CHECKED BY:	CNS

REV	DATE	DESCRIPTION
2	05/25/18	ISSUED FOR CONSTRUCTION
1	05/03/18	REISSUED FOR PERMITTING
0	07/12/16	ISSUED FOR PERMITTING



Professional Certification: I hereby certify that these documents were prepared or approved by me, and that I am a duly licensed professional engineer under the laws of the State of Maryland. License No. 49545. Expiration Date: 06/19/2025.

IT IS A VIOLATION OF LAW FOR ANY PERSON, UNLESS THEY ARE ACTING UNDER THE DIRECTION OF A LICENSED PROFESSIONAL ENGINEER, TO ALTER THIS DOCUMENT.



Professional Certification: I hereby certify that these documents were prepared or approved by me, and that I am a duly licensed professional engineer under the laws of the State of Maryland. License No. 49545. Expiration Date: 06/19/2025.

IT IS A VIOLATION OF LAW FOR ANY PERSON, UNLESS THEY ARE ACTING UNDER THE DIRECTION OF A LICENSED PROFESSIONAL ENGINEER, TO ALTER THIS DOCUMENT.



MD015_FREDERICK
ENERGY

NOTES

1. BOTTOM OF LOWEST SIGN TO BE INSTALLED 54" ABOVE GRADE.
2. SEE SHEET GN-3 FOR SIGN POST NOTES.
3. ADDITIONAL PARKING SIGNS TO BE INSTALLED 2" ABOVE TOP OF PREVIOUS SIGN.
4. DO NOT ANCHOR SIGNAGE OR PENETRATE SIDE OF SWITCHBOARD ASSEMBLY.
5. SIGNAGE TO BE REFLECTIVE VINYL.
6. SIGNAGE SHALL BE PRINTED WITH RED LETTERING ON A WHITE BACKGROUND.
7. ALL TEXT SHALL BE CAPITAL LETTERS. LABEL FONT SHALL BE ARIAL (OR SIMILAR) AND IS NOT TO BE BOLD.
8. CONTRAST BETWEEN CHARACTERS, SYMBOLS AND THEIR BACKGROUND SHALL BE 70% MINIMUM AND HAVE A NON GLARE FINISH.

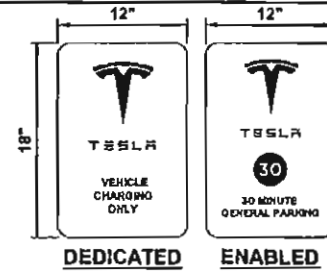

CHARGING POST SIGNAGE SCHEDULE		
SUPERCHARGER	CHARGE POST	SIGN(S) TO INSTALL
①	1A	ENABLED
	1B	ENABLED
②	2A	ENABLED
	2B	ENABLED
③	3A	ENABLED
	3B	ENABLED
④	4A	DEDICATED
	4B	DEDICATED
⑤	5A	DEDICATED
	5B	DEDICATED

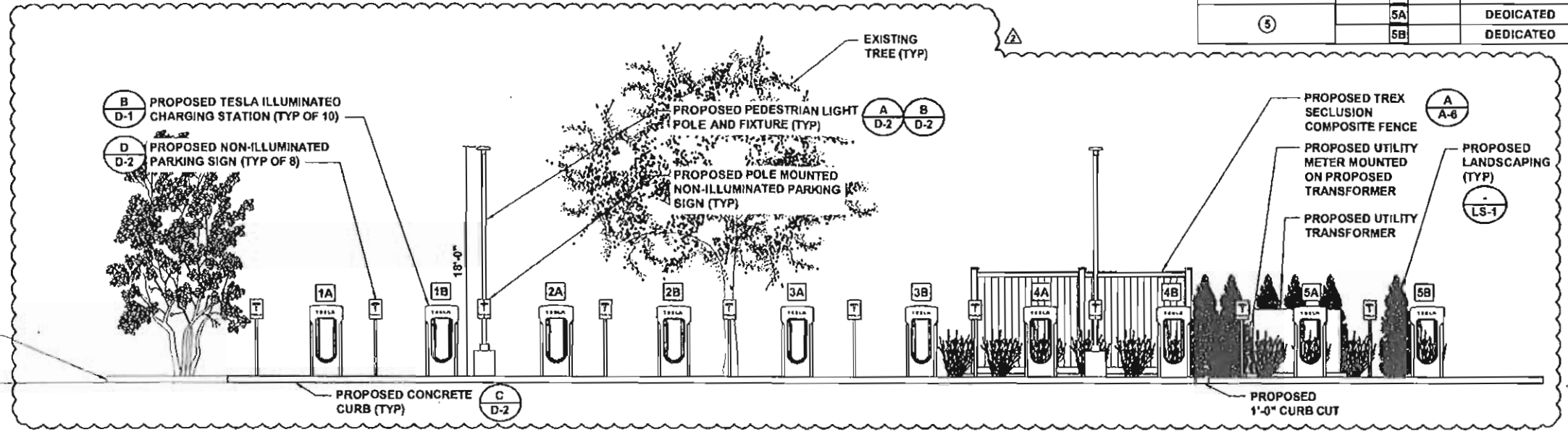
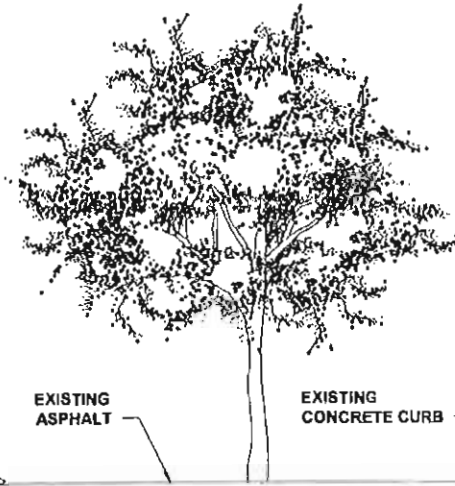

SITE ELEVATION

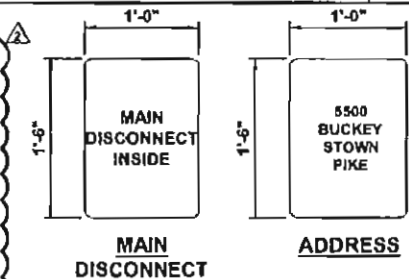
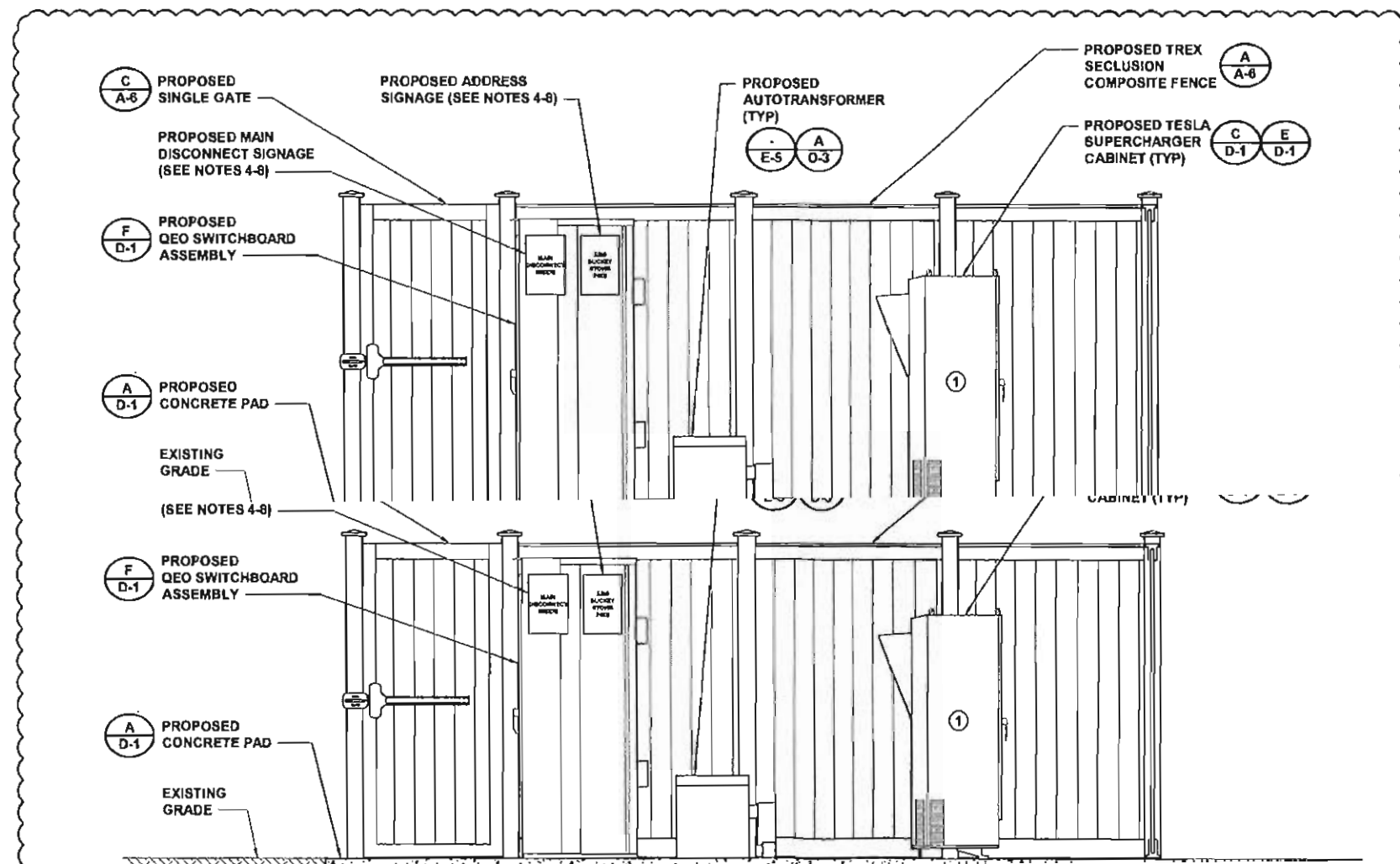
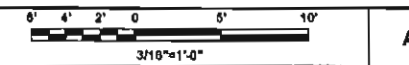

TESLA
MOTORS, INC.

3500 DEER CREEK RD
PALO ALTO, CA 94304
(800) 881-3000

BLACK & VEATCH

8500 W 115th St, Suite 2292
OVERLAND PARK, KS 66211
(913) 458-2000

PROJECT NO:	192745
DRAWN BY:	AKJ
CHECKED BY:	GNS

REV	DATE	DESCRIPTION
2	08/28/18	ISSUED FOR CONSTRUCTION
1	03/08/18	REISSUED FOR PERMITTING
0	07/12/18	ISSUED FOR PERMITTING

STATE OF MARYLAND
HYUN D. KIM
Professional Engineer
No. 49344
06/19/2020

Professional Certification. I hereby certify that these documents were prepared or approved by me, and that I am a duly licensed professional engineer under the Laws of the State of Maryland. License No. 49344. Expiration Date: 06/19/2020.

IT IS A VIOLATION OF LAW FOR ANY PERSON, UNLESS THEY ARE ACTING UNDER THE DIRECTION OF A LICENSED PROFESSIONAL ENGINEER, TO ALTER THIS DOCUMENT.

STATE OF MARYLAND
HYUN D. KIM
Professional Engineer
No. 49344
06/19/2020

Professional Certification. I hereby certify that these documents were prepared or approved by me, and that I am a duly licensed professional engineer under the Laws of the State of Maryland. License No. 49344. Expiration Date: 06/19/2020.

IT IS A VIOLATION OF LAW FOR ANY PERSON, UNLESS THEY ARE ACTING UNDER THE DIRECTION OF A LICENSED PROFESSIONAL ENGINEER, TO ALTER THIS DOCUMENT.

MD015-FREDERICK

NOTES

1. COLOR: SADDLE
2. PICK TREX SECLUSION COMPOSITE FENCE THAT MEETS THESE REQUIREMENTS. WIND SPEED = 115 MPH, SEISMIC: SDS = 2.49G, CATEGORY II.
3. TREX FENCING TO BE PROVIDED BY TESLA AND INSTALLED BY CONTRACTOR
4. CONTRACTOR SHALL DEVELOP REINFORCEMENT OF SLAB INTO FENCE PIER FOUNDATION AS SHOWN.

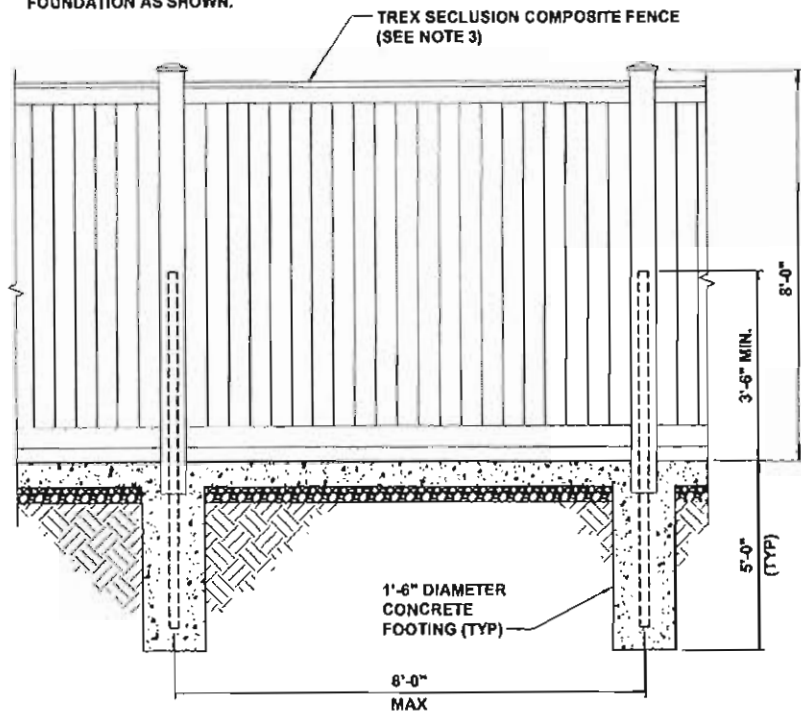

TREX FENCE ELEVATION

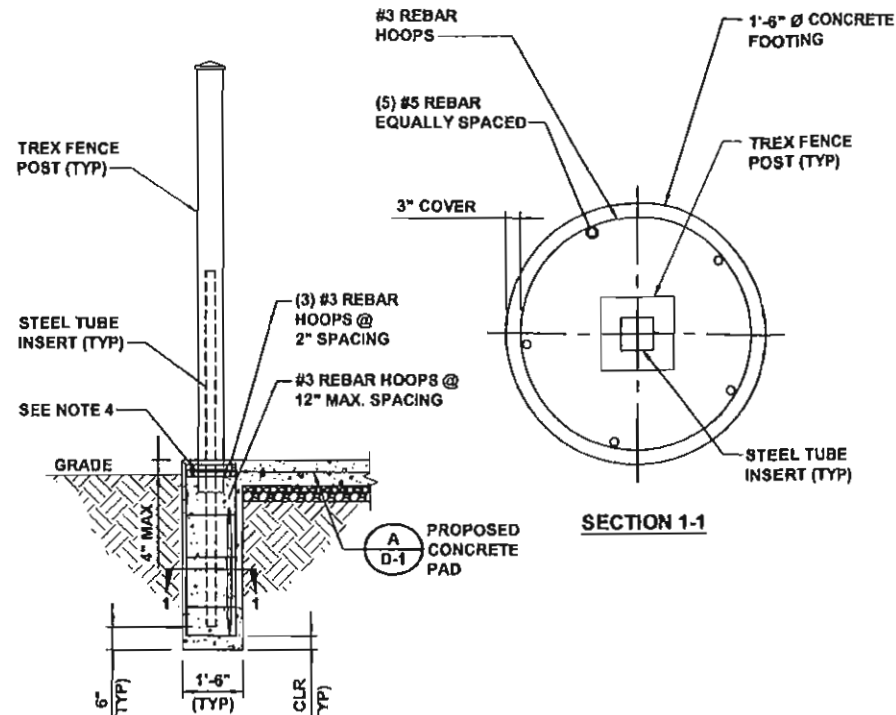

TYPICAL TREX FENCE ELEVATION

TYPICAL TREX FENCE DETAIL

NO SCALE

A

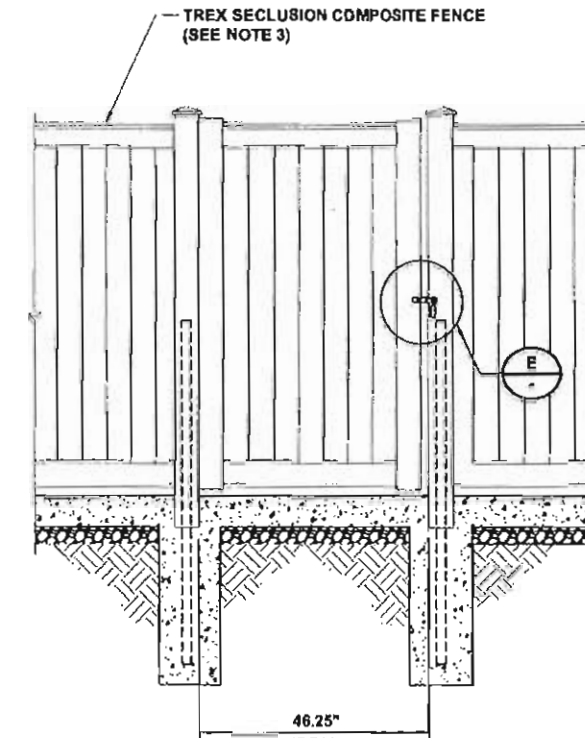

SINGLE GATE DETAIL

NO SCALE

B

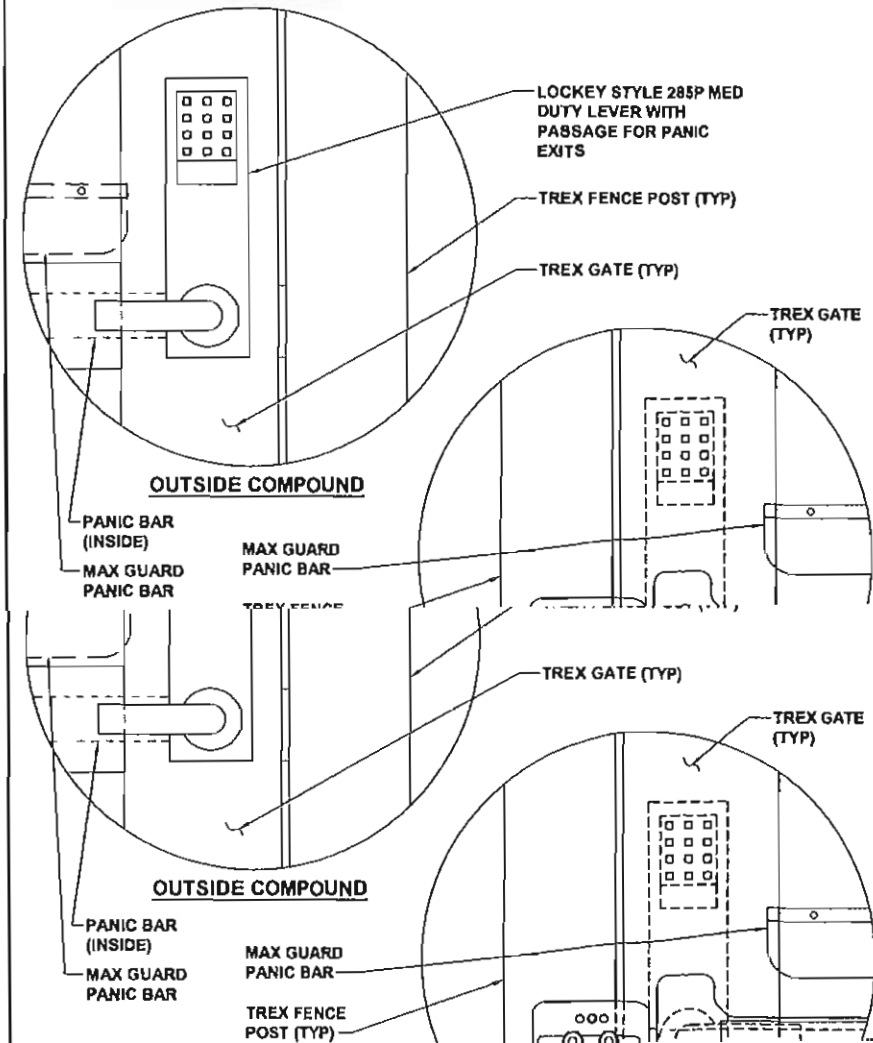
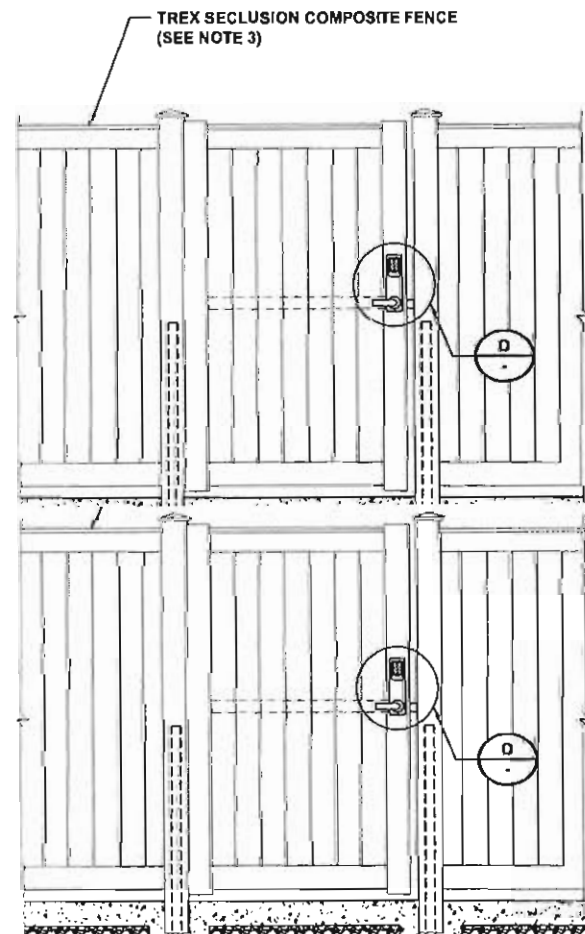

NOTE

1. HARDWARE NOT TO BE INSTALLED ON MEANS OF EGRESS GATES.

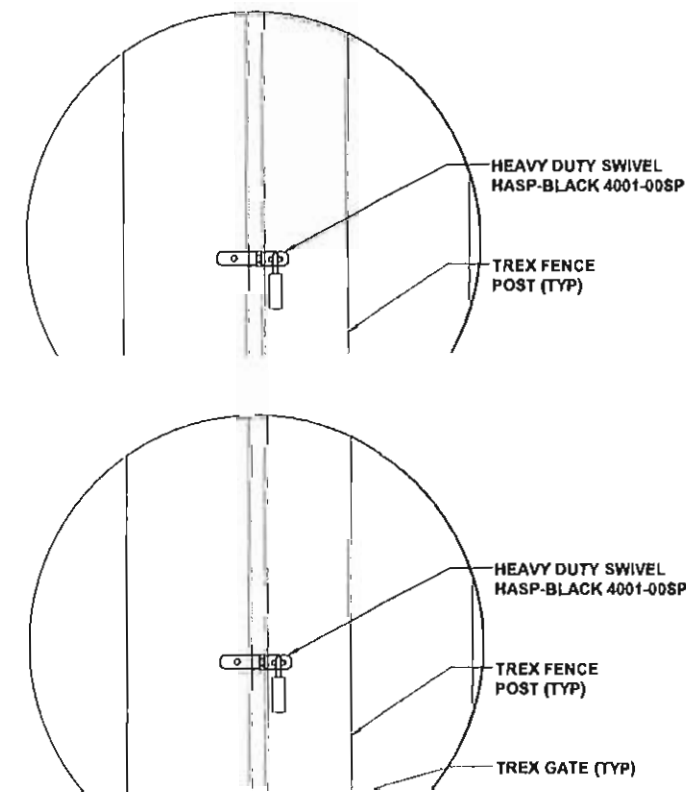

PROJECT NO:	102745
DRAWN BY:	AKJ
CHECKED BY:	CNS

REV	DATE	DESCRIPTION
2	08/28/18	ISSUED FOR CONSTRUCTION
1	08/08/18	REISSUED FOR PERMITTING
0	07/12/18	ISSUED FOR PERMITTING

STATE OF MARYLAND
HYUN D. KIM, LAND
08/28/18
PROFESSIONAL ENGINEER

Professional Certification. I hereby certify that these documents were prepared or approved by me, and that I am a duly bonded professional engineer under the laws of the State of Maryland. License No. 49543, Expiration Date: 06/19/2020

IT IS A VIOLATION OF LAW FOR ANY PERSON, UNLESS THEY ARE ACTING UNDER THE DIRECTION OF A LICENSED PROFESSIONAL ENGINEER, TO ALTER THIS DOCUMENT.

STATE OF MARYLAND
HYUN D. KIM, LAND
08/28/18
PROFESSIONAL ENGINEER

Professional Certification. I hereby certify that these documents were prepared or approved by me, and that I am a duly bonded professional engineer under the laws of the State of Maryland. License No. 49543, Expiration Date: 06/19/2020

IT IS A VIOLATION OF LAW FOR ANY PERSON, UNLESS THEY ARE ACTING UNDER THE DIRECTION OF A LICENSED PROFESSIONAL ENGINEER, TO ALTER THIS DOCUMENT.

MD015 FREDERICK
ERENEDICK

TESLA
MOTORS, INC.

3500 DEER CREEK RD
PALO ALTO, CA 94304
(650) 681-5000

BLACK & VEATCH

6800 W 115th St, Suite 2202
OVERLAND PARK, KS 66211
(913) 458-2000

NOTES

1. BUILDING CONTRACTORS SHOULD ADD 22 FEET TO THE HORIZONTAL RUN LENGTH TO ACCOUNT FOR BURIED DEPTH.
2. THE UTILITY DESIGN DETAILS SUMMARIZED ON THIS SHEET ARE FOR PROPERTY OWNER REVIEW. THE CONTRACTOR SHALL REFERENCE THE UTILITY DESIGN PACKAGE (UDP), PROVIDED WITH THE "ISSUED FOR CONSTRUCTION" DRAWINGS FOR BIDDING. THE CONTRACTOR SHALL INSTALL THE UTILITY RELATED SCOPE OF WORK PER UTILITY CONSTRUCTION SPECIFICATION REQUIREMENTS.
3. UTILITY EQUIPMENT INSTALLATIONS AND PREP WORK AND TERMINATION OF SERVICE CONDUCTORS SHALL BE COORDINATED WITH THE APPROPRIATE UTILITY ENGINEER AT TIME OF PRECONSTRUCTION MEETING TO ENSURE ACCURACY OF INSTALLATIONS.
4. TRANSFORMER BOLLARD PROTECTION TO BE INSTALLED PER UTILITY SPECIFICATION. ADDITIONAL BOLLARD PROTECTION MAY BE REQUIRED AT THE DISCRETION OF THE UTILITY FIELD INSPECTION PERSONNEL.
5. CONTRACTOR SHALL CONTACT UTILITY TO HAVE THE PRIMARY ROUTE AND SWITCHING CABINET LOCATIONS STAKED BY UTILITY PERSONNEL. CONTRACTOR SHALL INSTALL PRIMARY CONDUIT AND EQUIPMENT PADS PER UTILITY DIRECTION.

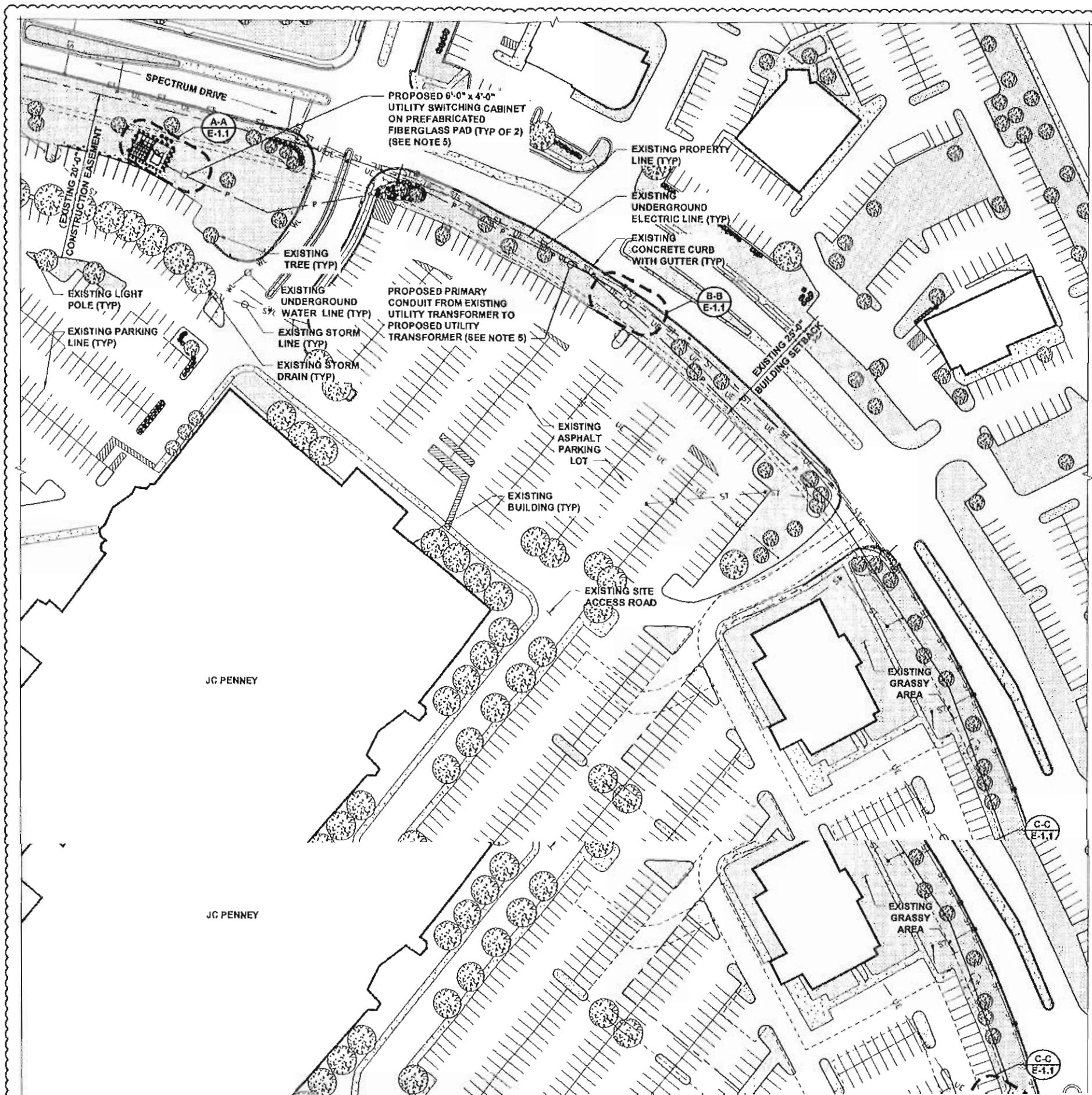

3500 DEER CREEK RD
PALO ALTO, CA 94304
(650) 681-3000



BLACK & VEATCH

6800 W 115th St, Suite 2292
OVERLAND PARK, KS 66211
(913) 458-2000

PROJECT NO:	192745
DRAWN BY:	AMJ
CHECKED BY:	CNS

REV	DATE	DESCRIPTION
7	05/20/18	ISSUED FOR CONSTRUCTION
1	04/05/18	REISSUED FOR PERMITTING
8	07/12/16	ISSUED FOR PERMITTING



Professional Certification. I hereby certify that these documents were prepared or approved by me, and that I am a duly licensed professional engineer under the laws of the State of Maryland. License No. 49541. Expiration Date: 06/19/2020.

IT IS A VIOLATION OF LAW FOR ANY PERSON, UNLESS THEY ARE ACTING UNDER THE DIRECTION OF A LICENSED PROFESSIONAL ENGINEER, TO ALTER THIS DOCUMENT.

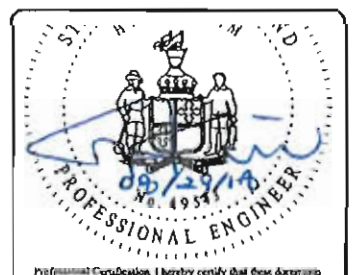

Professional Certification. I hereby certify that these documents were prepared or approved by me, and that I am a duly licensed professional engineer under the laws of the State of Maryland. License No. 49541. Expiration Date: 06/19/2020.

IT IS A VIOLATION OF LAW FOR ANY PERSON, UNLESS THEY ARE ACTING UNDER THE DIRECTION OF A LICENSED PROFESSIONAL ENGINEER, TO ALTER THIS DOCUMENT.

MD015_FREDERICK
CORPORATION

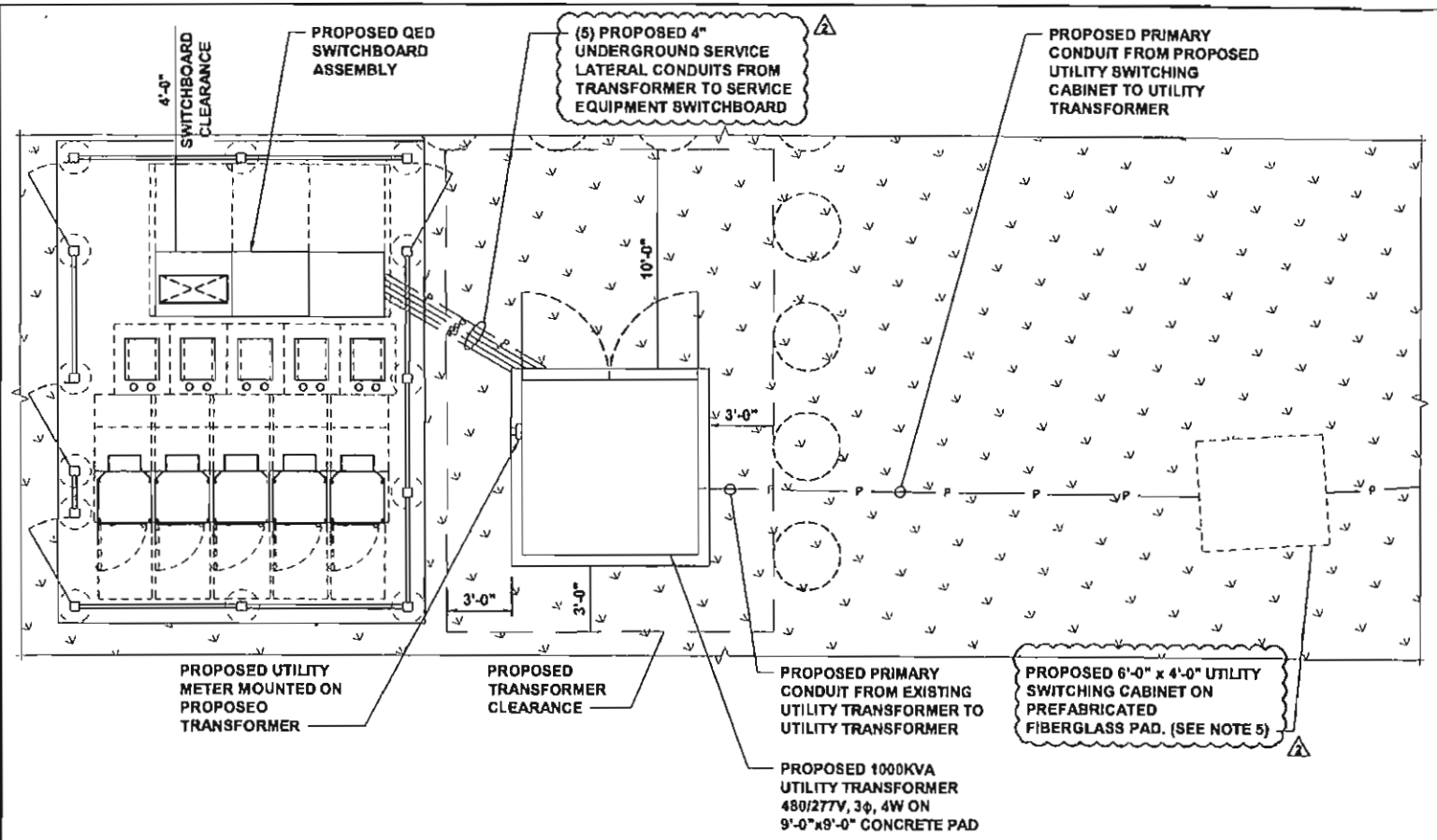

PLAN A-A
SCALE: NO SCALE

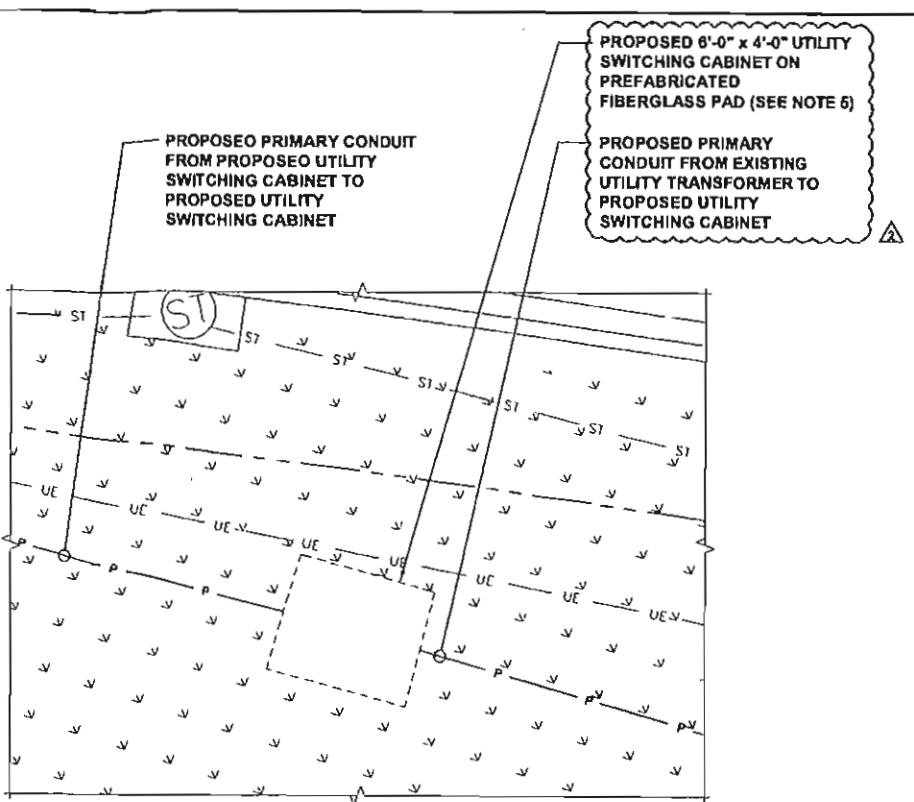

PLAN B-B
SCALE: NO SCALE

- NOTES**
- BUILDING CONTRACTORS SHOULD ADD 22 FEET TO THE HORIZONTAL RUN LENGTH TO ACCOUNT FOR BURIED DEPTH.
 - THE UTILITY DESIGN DETAILS SUMMARIZED ON THIS SHEET ARE FOR PROPERTY OWNER REVIEW. THE CONTRACTOR SHALL REFERENCE THE UTILITY DESIGN PACKAGE (UDP), PROVIDED WITH THE "ISSUED FOR CONSTRUCTION" DRAWINGS FOR BIDDING. THE CONTRACTOR SHALL INSTALL THE UTILITY RELATED SCOPE OF WORK PER UTILITY CONSTRUCTION SPECIFICATION REQUIREMENTS.
 - UTILITY EQUIPMENT INSTALLATIONS AND PREP WORK AND TERMINATION OF SERVICE CONDUCTORS SHALL BE COORDINATED WITH THE APPROPRIATE UTILITY ENGINEER AT TIME OF PRECONSTRUCTION MEETING TO ENSURE ACCURACY OF INSTALLATIONS.
 - TRANSFORMER BOLLARD PROTECTION TO BE INSTALLED PER UTILITY SPECIFICATION. ADDITIONAL BOLLARD PROTECTION MAY BE REQUIRED AT THE DISCRETION OF THE UTILITY FIELD INSPECTION PERSONNEL.
 - CONTRACTOR SHALL CONTACT UTILITY TO HAVE THE PRIMARY ROUTE AND SWITCHING CABINET LOCATIONS STAKED BY UTILITY PERSONNEL. CONTRACTOR SHALL INSTALL PRIMARY CONDUIT AND EQUIPMENT PADS PER UTILITY DIRECTION.
 - HAND DIG TRENCH IN THIS LOCATION TO AVOID EXISTING UNDERGROUND ELECTRIC LINE. CONTACT ENGINEER IF UNDERGROUND ELECTRIC LINE CONFLICTS WITH PROPOSED INSTALLATION.

- SERVICE CONDUCTORS SHALL BE COORDINATED WITH THE APPROPRIATE UTILITY ENGINEER AT TIME OF PRECONSTRUCTION MEETING TO ENSURE ACCURACY OF INSTALLATIONS.
- TRANSFORMER BOLLARD PROTECTION TO BE INSTALLED PER UTILITY SPECIFICATION. ADDITIONAL BOLLARD PROTECTION MAY BE REQUIRED AT THE DISCRETION OF THE UTILITY FIELD INSPECTION PERSONNEL.
 - CONTRACTOR SHALL CONTACT UTILITY TO HAVE THE PRIMARY ROUTE AND SWITCHING CABINET LOCATIONS STAKED BY UTILITY PERSONNEL. CONTRACTOR SHALL INSTALL PRIMARY CONDUIT AND EQUIPMENT PADS PER UTILITY DIRECTION.
 - HAND DIG TRENCH IN THIS LOCATION TO AVOID EXISTING UNDERGROUND ELECTRIC LINE. CONTACT ENGINEER IF UNDERGROUND ELECTRIC LINE CONFLICTS WITH PROPOSED INSTALLATION.

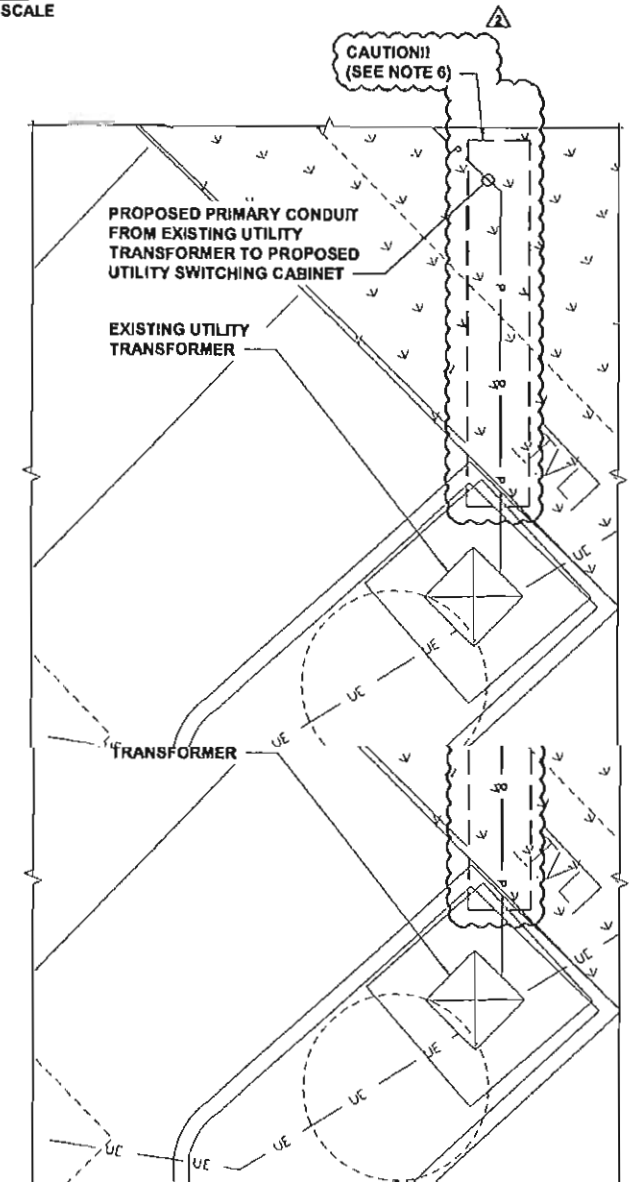

3500 DEER CREEK RD
PALO ALTO, CA 94304
(650) 681-5000



6800 W 115th St, Suite 2292
OVERLAND PARK, KS 66211
(813) 458-2000

PROJECT NO:	192745
DRAWN BY:	AKJ
CHECKED BY:	CNS

REV	DATE	DESCRIPTION
2	08/28/18	ISSUED FOR CONSTRUCTION
1	05/04/18	RESUBMITTED FOR PERMITTING
0	07/12/18	ISSUED FOR PERMITTING



Professional Certification: I hereby certify that these documents were prepared or approved by me, and that I am a duly licensed professional engineer under the laws of the State of Maryland. License No. 49543, Expiration Date: 06/19/2020.

IT IS A VIOLATION OF LAW FOR ANY PERSON, UNLESS THEY ARE ACTING UNDER THE DIRECTION OF A LICENSED PROFESSIONAL ENGINEER, TO ALTER THIS DOCUMENT.



Professional Certification: I hereby certify that these documents were prepared or approved by me, and that I am a duly licensed professional engineer under the laws of the State of Maryland. License No. 49543, Expiration Date: 06/19/2020.

IT IS A VIOLATION OF LAW FOR ANY PERSON, UNLESS THEY ARE ACTING UNDER THE DIRECTION OF A LICENSED PROFESSIONAL ENGINEER, TO ALTER THIS DOCUMENT.

MD016 FREDERICK ENERGY

NOTES

1. BIDDING CONTRACTORS SHOULD ADD 16 FEET TO THE HORIZONTAL AC CONDUCTOR RUN LENGTH, AND 22 FEET TO THE HORIZONTAL DC CONDUCTOR RUN LENGTH TO ACCOUNT FOR BURIED DEPTH.
2. THE EXACT ROUTING PATH AND CONDUCTOR RUN LENGTHS SHALL BE DETERMINED BY THE CONTRACTOR IN THE FIELD BASED ON PHYSICAL MEASUREMENTS. CONTRACTOR TO ORDER CONDUCTOR BASED ON FIELD MEASUREMENTS (MUST BE APPROVED BY TESLA INSTALLATION MANAGER).
3. ALL ELECTRICAL WORK AND RELATED ACTIVITIES PERFORMED ON-SITE SHALL BE DONE IN ACCORDANCE WITH NATIONAL ELECTRIC CODE (NEC) STANDARDS BEING ENFORCED BY ALL APPLICABLE JURISDICTIONAL REQUIREMENTS AT THE TIME OF CONSTRUCTION.
4. THE MAXIMUM RUN LENGTH BETWEEN SUPERCHARGER CABINET AND CHARGING POST, INCLUDING BURIED DEPTH IS NOT TO EXCEED 160'. ANY LENGTH BEYOND THIS MAXIMUM SHALL INCLUDE AN RG-6 COAX CABLE RUN IN A SEPARATE 1" CONDUIT.

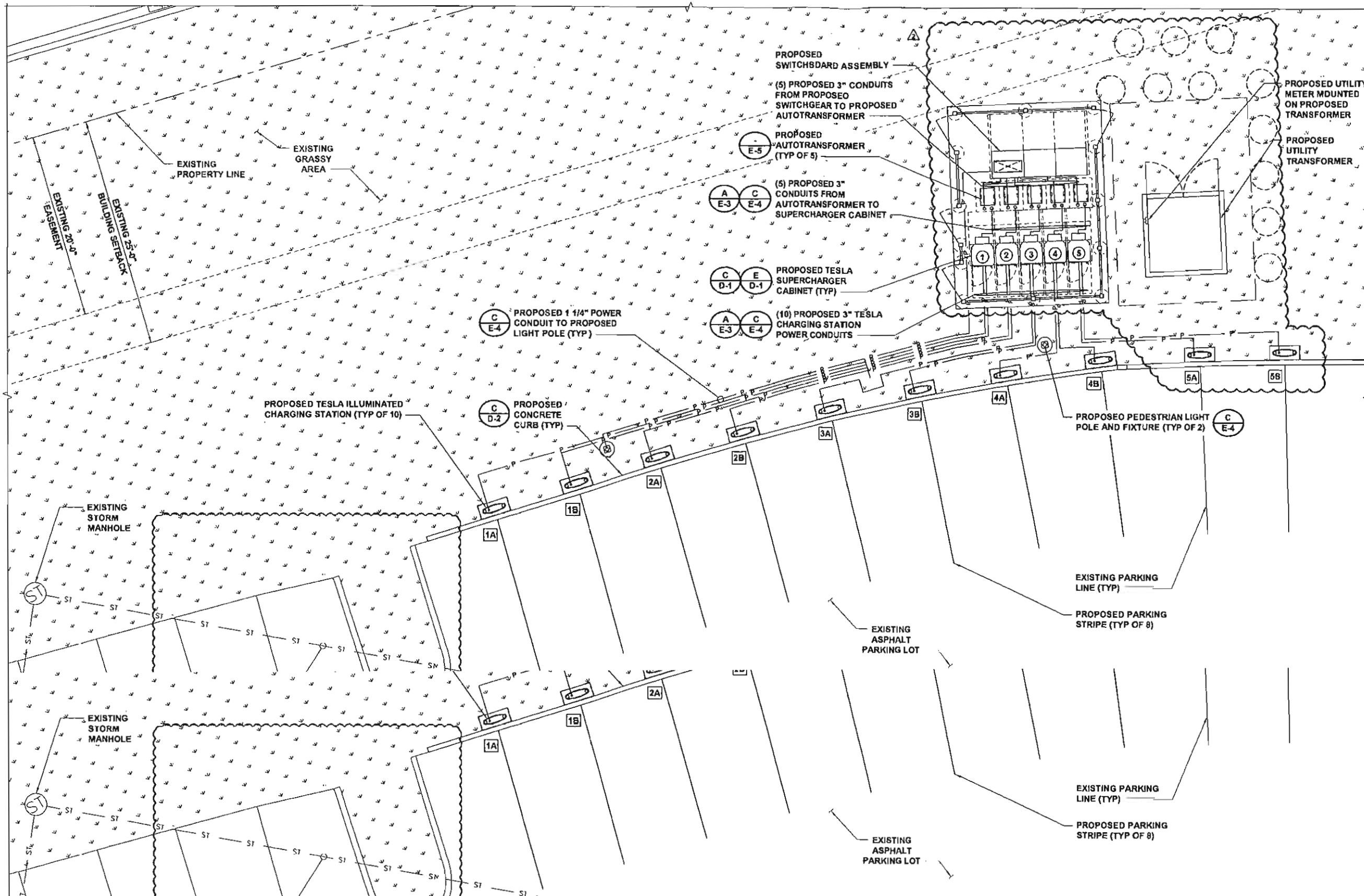

3500 DEER CREEK RD
PALO ALTO, CA 94304
(650) 881-6000



6800 W 115th St, Suite 2202
OVERLAND PARK, KS 66211
(913) 458-2000

PROJECT NO:	192745
DRAWN BY:	AKJ
CHECKED BY:	CNS

REV	DATE	DESCRIPTION
2	06/28/18	ISSUED FOR CONSTRUCTION
1	06/05/18	ISSUED FOR PERMITTING
0	07/12/18	ISSUED FOR PERMITTING



Professional Certification. I hereby certify that these documents were prepared or approved by me, and that I am a duly licensed professional engineer under the laws of the State of Maryland. License No. 4934; Expiration Date: 06/19/2020.

IT IS A VIOLATION OF LAW FOR ANY PERSON, UNLESS THEY ARE ACTING UNDER THE DIRECTION OF A LICENSED PROFESSIONAL ENGINEER, TO ALTER THIS DOCUMENT.



Professional Certification. I hereby certify that these documents were prepared or approved by me, and that I am a duly licensed professional engineer under the laws of the State of Maryland. License No. 4934; Expiration Date: 06/19/2020.

IT IS A VIOLATION OF LAW FOR ANY PERSON, UNLESS THEY ARE ACTING UNDER THE DIRECTION OF A LICENSED PROFESSIONAL ENGINEER, TO ALTER THIS DOCUMENT.

MD015_FREDERICK
FREDERICK